

Flag Day 5K

VA Hospital, Lyons, NJ 07939

NJ14514JHP

Effective 4/18/2014 to 12/31/2024



ALL DIRECTIONS ARE GIVEN RELATIVE TO THE RUNNING DIRECTION.

Start: On SW Gate No. 2 Road, at black lamp post on the west side of the road just south of the parking area for Building 13. Black lamp post is just south of the yellow road gate posts.

Mile 1: On Knollcroft, 4 feet 6 inches after the second black lamp post on the left (west) after the golf course/driving range driveway on the right.

Mile 2: On Orchard, 13 feet 6 inches after the storm drain on the left (south) side of the road that leads to the Post Office. It is the third access road on the left.

Turnaround: On Orchard, 18 feet 6 inches before (east of) the black lamp post on the right (north) side at Building 135. Turnaround is also at the western edge of the loading dock garage door to Building 135.

Mile 3: On W. Circle 35 feet before the leading edge of the storm drain at the intersection of W. Circle and SW Gate No. 2 Road and even with the large black vent pipes on the right.

Finish: In the parking lot 10 inches north of the 4th yellow bollard counting south to north on the eastern side of the gray metal storage building and 13 feet 3 inches north of the lamp post at the southern end of the gray metal storage building.

Course Notes: The course is run in a counterclockwise direction. Runners run on the path on the north side of Valley Road. Runners keep the center island on their left when turning from the path onto Knollcroft. Runners keep guard house on their left when turning from E. Circle to Knollcroft.

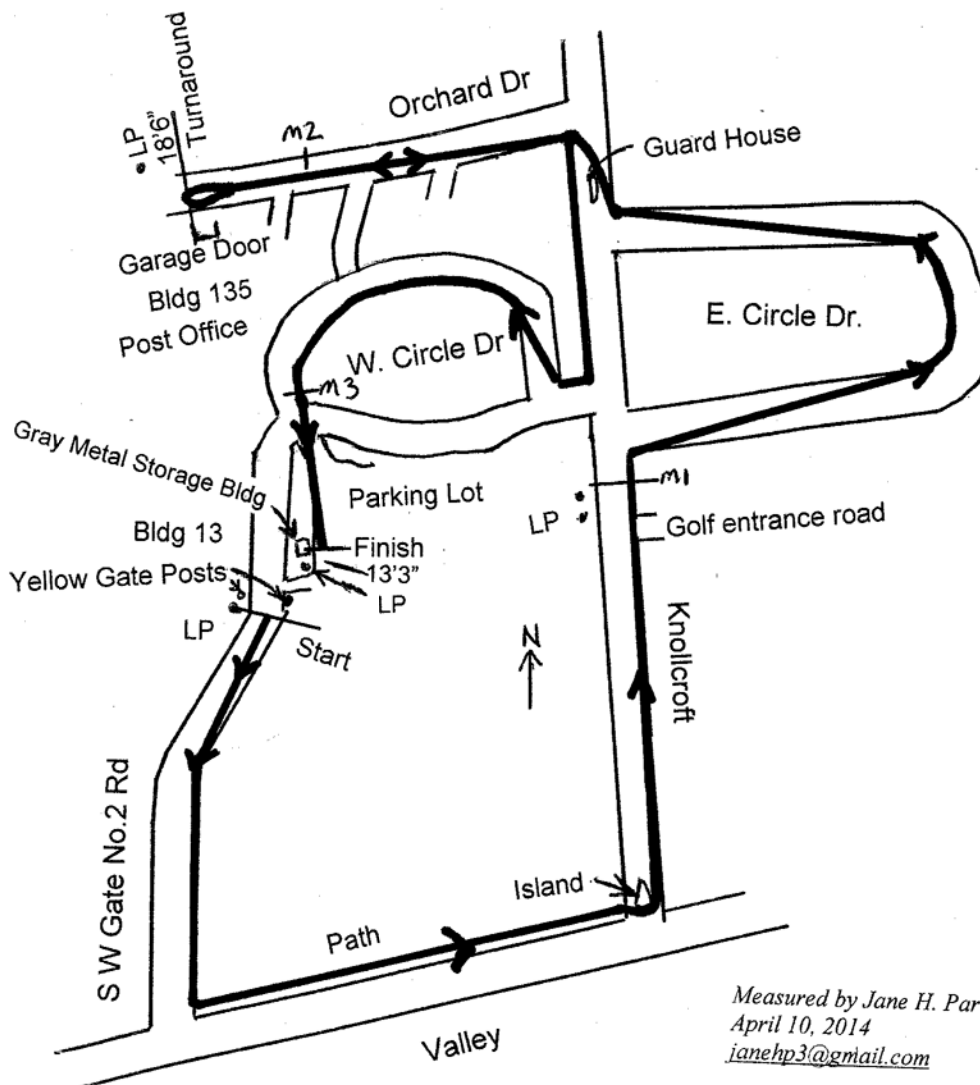

Measured by Jane H. Parks
April 10, 2014
janehp3@gmail.com